

Franklyn James



Westferry Road

Isle of Dogs, London, E14 3RS

Guide Price £650,000

FREEHOLD - GUIDE PRICE £650,000 - £675,000 A charming three-bedroom terraced Victorian home, positioned on the well-connected Westferry Road. Internally the property comprises an open plan living/dining area with bayed windows to the front allowing plenty of natural light, separate fully fitted kitchen, and downstairs four-piece family bathroom suite. On the first floor you will find three bedrooms, two doubles and good-sized single which will make for a perfect home office. Further benefits include an additional first floor WC, good sized east facing garden,

Westferry Road is located on the West coast of the Isle of Dogs, close to the Thames Path. Mudchute DLR Station is located just 0.6 miles from the property and provides a regular service in Canary Wharf and Bank. As well as Canary Wharf Jubilee line being a 15-minute walk away, offering easy access into The City and beyond. You will also find an abundance of shops, eateries and parks located on Westferry Road.

Please contact our Limehouse Sales Office on 02077911777 if you wish to arrange a viewing appointment for this property or require further information.



Floor Plan

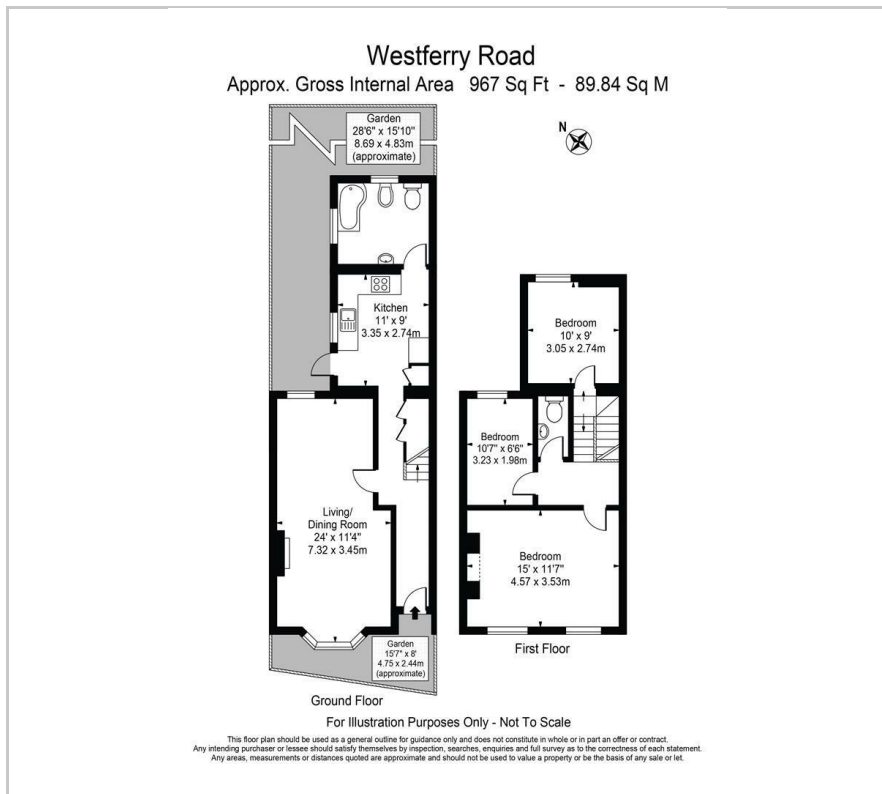

Area Map

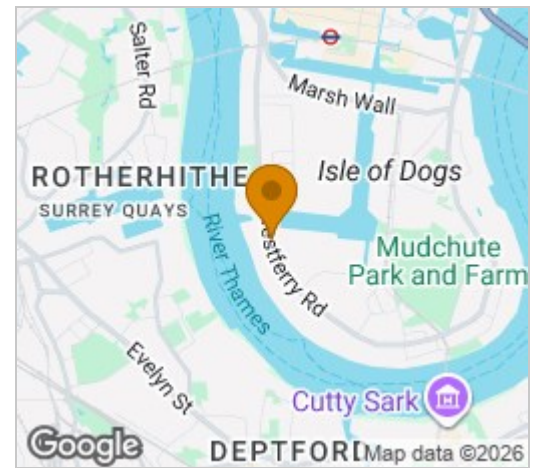

Energy Efficiency Graph

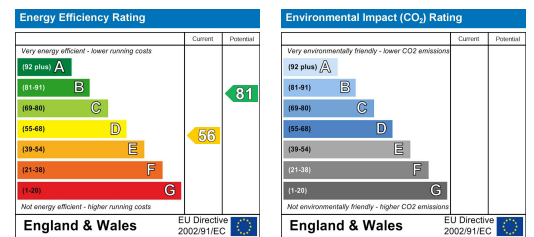

These particulars, whilst believed to be accurate are set out as a general outline only for guidance and do not constitute any part of an offer or contract. Intending purchasers should not rely on them as statements of representation of fact, but must satisfy themselves by inspection or otherwise as to their accuracy. No person in this firm's employment has the authority to make or give any representation or warranty in respect of the property.